

Ashtons



6 Furness Drive YO30 5TD

£1,150 Per Month

2



1



1



C

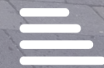

This recently updated 2 bedroom bungalow is located in the popular residential area of Rawcliffe to the North of York with easy access to the city centre, outer ring road and A19. The property is offered on an unfurnished basis and briefly comprises; Entrance hallway, Large living room, bathroom with shower over bath, modern fitted kitchen with oven, hob, fridge freezer and washing machine, separate WC and two double bedrooms. Enclosed garden to the rear with a shed and driveway for two cars.

Available Now

Initial 6 month tenancy / Deposit £1250pcm / Council Tax Band C / EPC Rating C

Would consider a pet

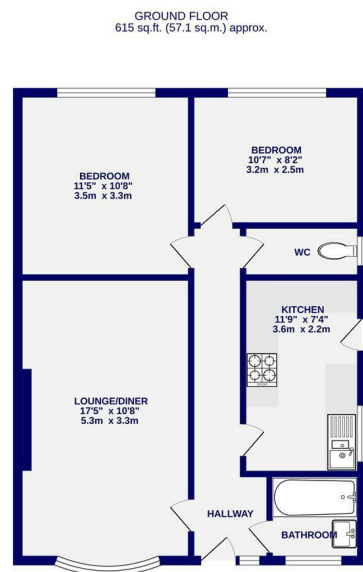

TOTAL FLOOR AREA: 615 sq ft. (57.1 sq.m.) approx.
While every effort has been made to ensure the accuracy of the floorplan, measurements of rooms and any other areas are approximate. It is not to be used for legal purposes and is for guidance only. The plan is for illustrative purposes only and should be used as a guide only for prospective purchasers. The contents, layout and appearance shown shall be deemed to be approximate and is subject to change without notice.



Ashtons Lettings

01904 731404

lettings@ashtonsnet.com

